

Open Plan, Open Minds.

Product Overview



cubicles.com

#21860-6

888-442-8242



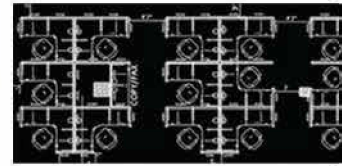

Open Plan, Open Minds.

...Workstation Solutions for the 21st Century

More than half our life is dedicated to our work. So much of this work is conducted and transacted within and across this ubiquitous thing called office furniture that we often forget it's even there.

Cubicles.com is dedicated to assisting you with affordably fulfilling your vision for a new office environment. We work with you to create an open office plan that maximizes available square footage, optimizes workflow and engages the human spirit in a symphony of employee collaboration.

Our Open Plan Systems began by remanufacturing Herman Miller AO2 workstations and have been at the forefront of the remanufactured cubicle since the mid 1980's with thousands of customers and an extensive base of installations throughout the country.

From these remanufactured roots, OPS tooled and retooled to be better than most. Better by offering you the versatility of choice, built upon the foundation of the first (and still best) engineered office cubicle system ever to be devised.



cubicles.com



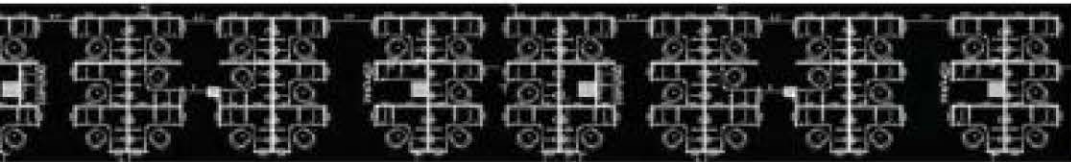

Table of Contents

■ OPS2 Signature Series.....	4
• Panel Systems	
• Tile Systems	
• Modular Walls	
■ OPS2 Sustainable / Remanufactured Series	10
• Why Go Green	
• 1-Week Lightning Program	
■ Storage & Accessories	15
■ Seating	20
■ Design Capabilities	21
• CAD	
• Space Planning Services	
■ The Open Plan Advantage.....	22



Your Office Will Never Be The Same!

Serving the Nation: NY | Boston | Atlanta | Miami | Tampa | Washington DC | Virginia | Philadelphia | Denver | San Diego | Dallas | Houston | Los Angeles | Chicago

888-442-8242

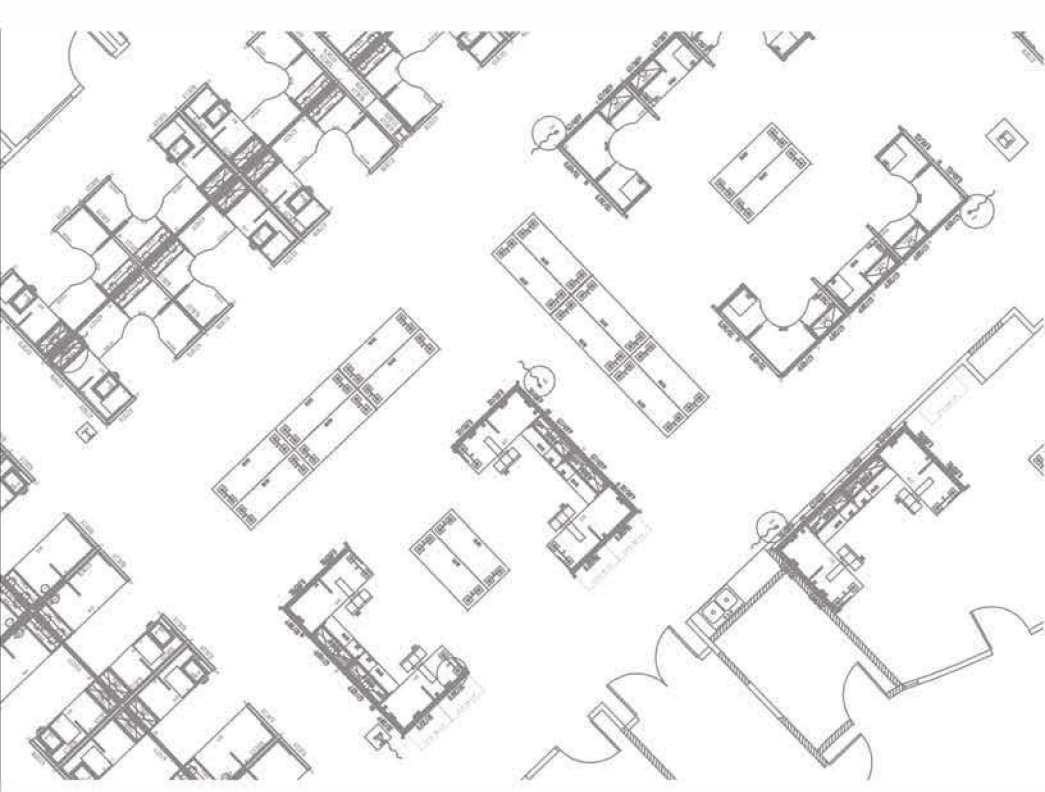

OPS2 Signature Series

More efficient office work space



#23215-2



cubicles.com

888-442-8242



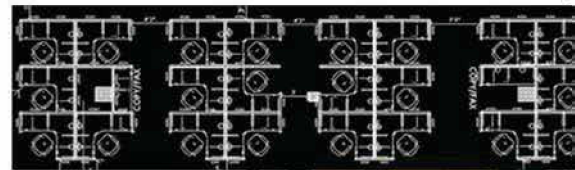

OPS2 Signature Series

OPS2 Signature Series is a newly manufactured cubicle workstation product **MADE IN THE USA**. OPS2 has been optimized for versatility with the ability to customize your workstations with benching options, glass and fabric mullions, glass tile stackers, and our largest selection of fabrics and finishes. OPS2 Signature Series can be specified with Monolithic Panels, Segmented/Tiled Panels, and Modular Walls.

Panels

Greatest Flexibility

Designers will enjoy the flexibility and variety of the OPS2 Panel Systems, which has the largest selection of fabrics and finishes among our programs.

With the number of options available, Open Plan has just what you need for any project.



Make the most of your office space by dividing open areas into smaller collaborative work stations.

#14407-2

Tiles

Evolution of Work Space

Tile systems give you the flexibility to mix, match or contrast colors, materials and finishes to add a touch of refinement (or pizzazz!) to any setting.

Create a designer look at a budget price with the OPS2 Tile System. Available in all Signature fabrics and finishes and compatible with existing Herman Miller AO2™ workstations and accessories.



#26796-2

Modular Walls

Refine Your Space

In a collaborative work environment, modular walls allow for the open plan concept paired with the management of noise and distractions.

Create a floor to ceiling 9-foot high modular conference room or a few private offices with doors at a fraction of the cost of the common go-to alternative: sheetrock.



#33209-1



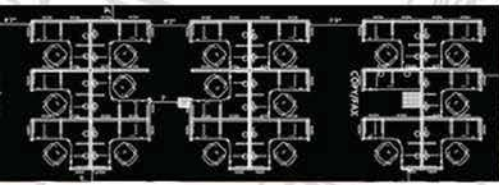

Panels - Greatest Flexibility



So flexible, in fact, that we can even build you stations with no panels at all! Electrical options and wire management are still available even if not managed with panels.



Need more traditional, private spaces, but want to add flare? Top your panels with glass stackers - available in clear, frosted, smoked, or ribbed.



Mix and Match up to seven different panel heights that allow for storage capability without feeling boxed in.

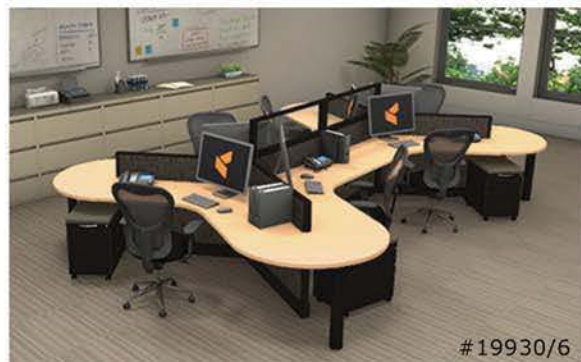

Break up your straight edge pathways and create dimension to your workflows with "dogbone" clusters. Works best with mobile pedestals.



Need ultimate privacy, but wish to avoid the hassle of sheetrock walls? use 85"H panels with a locking door.



Finish your office space with a customized reception station that matches your office cubicles.



cubicles.com

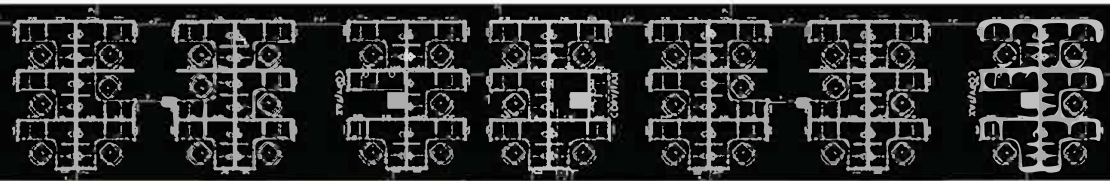

Tiles - Evolution of Workspace

As the work place continues to evolve, so should your work space!

The OPS2 Tile System gives you the flexibility and adaptability to create a unique look for your office interior and evolve with the future.

Specify tiled panels that accent private office or conference room furniture. You can add "wow" to your office interior by specifying accent tiles that complement flooring or window treatments!

OPS2 Tiles are available in glass, open frame and perforated metallic, along with a wide variety of acoustical tiles covered with fabrics offered in our Signature Series.

Like the OPS2 monolithic panels, OPS2 Tiles are also compatible with existing Herman Miller AO2™ style workstations and accessories.

Tile Heights	Tile Widths	Tile Frame Heights	Tile Stacker Heights	Add Tile Stackers to Achieve
★ 7"	★ 24"	★ 39"	★ 8"	★ 47" H
★ 14"	★ 30"	★ 53"	★ 14"	★ 85" H
★ 18"†	★ 36"	★ 67"	★ 18"†	★ 103" H
	★ 42"			
	★ 48"			

† 18" H can be used as bottom tile or 18" stacker only.

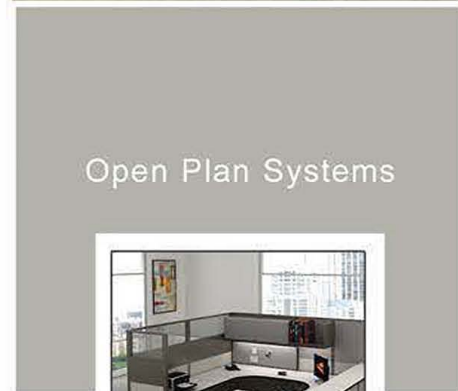

cubicles.com



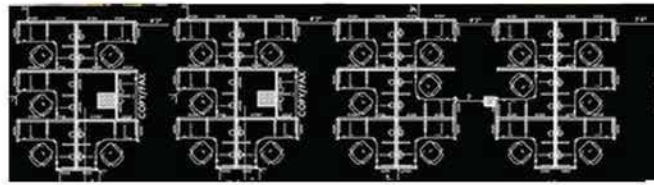

Modular Walls - Refine your space



#33209-1

Refine Your Space.

In today's collaborative work environment, modular walls allow for the open plan concept paired with the management of noise and distraction. Create a new conference room or private office at a fraction of the cost of alternative solutions with these floor to ceiling modular walls and doors that accommodate ceilings up to 9 feet high. With finish options aplenty - fabric, acoustic and laminate - our modular panel walls are sure to satisfy your designer's aesthetic, your facility manager's demand for durable quality, and your CFO's bottom line.

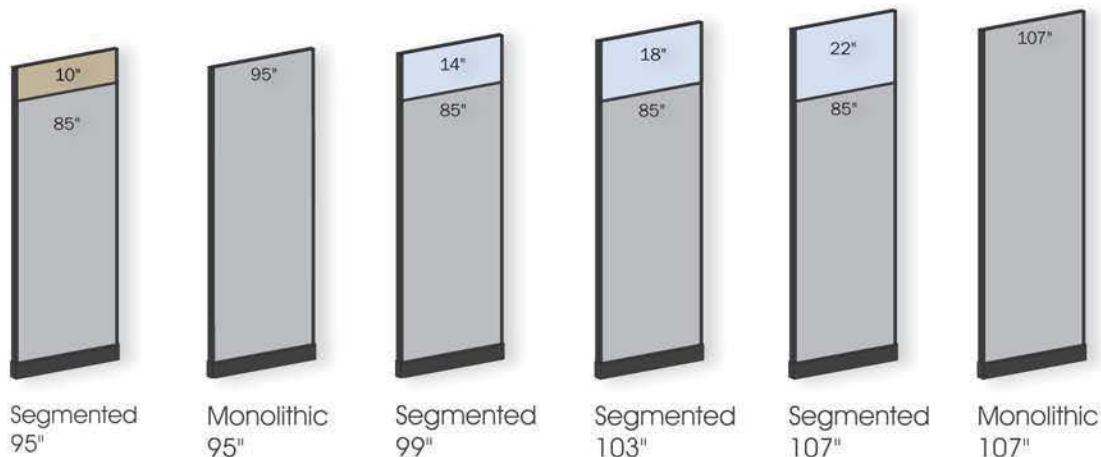

Available in Fabric, Acoustic, & Laminate Panels

85H available in monolithic or segmented options.

Fabric Only
 Fabric or Glass



cubicles.com

888-442-8242



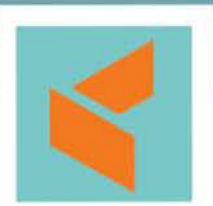
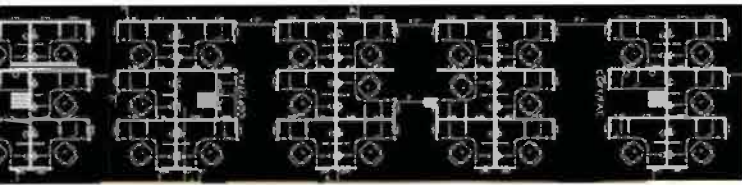

Signature Finishes

Visit www.cubicles.com/o2-finishes for all color options.

Fabric Families (Over 300 total fabrics available)



Work Surface



Base



Trim



Edge

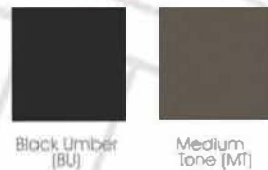

Note: These edge finishes are in addition to the work surface matches denoted with the § symbol. Colors shown are for representative purposes only. Actual swatches are available upon request.



cubicles.com





OPS2 Sustainable Series - Eco - Friendly!



#18797/6



cubicles.com

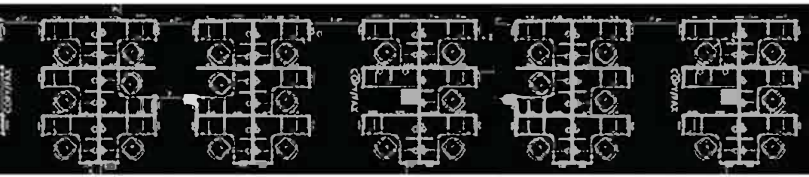

OPS2 Sustainable Series

re-man-u-fac-ture [rè-, ma-nyə-'fak-chər] (verb): *to manufacture into a new product*

Remanufactured cubicles provide a world of savings and sustainability, and are held to the same standards of quality and durability as brand new product. Saving up to 40% off the cost of new product manufactured from newly sourced raw materials is the most noticeable advantage. The potential to earn LEED points as recognition for your wise stewardship of our planet's natural resources is another. The valued selections in the Promotional and C2 Programs allow us to provide our greatest discounts through the remanufacturing of panel cores, connector cores, and overhead storage bins.



#17967/2



#12575/4

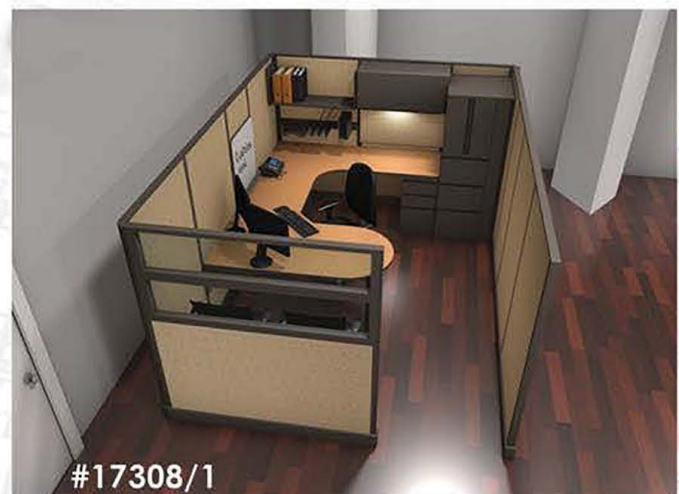

#17308/1



Why go Green?

With Our Green Solution, you will receive assurances that come with our lifetime warranty and UL Listing (Class A safety rating), with savings up to 40% off the cost of new! 100% of the products we purchase are either reused or recycled.

At Open Plan Systems, sustainability is more than just re-using product. It includes our recycling programs for all incoming components that are not suitable for remanufacture. Further, our manufacturing facility utilizes energy conscious lighting and employs an enhanced management philosophy for optimum efficiency.

Here's how we do it...

What is remanufacturing?

Remanufacturing is a process that strips goods down to their raw state where they are then manufactured to the same standards and appearance of new office furniture!

What else is different between New and Remanufactured systems?

	Remanufactured	New
Top Cap	Plastic	Aluminum
Rails	Version 1 (2 pieces)	Version 2 (1 piece)
Power	Version 1 (Festoons are needed to power from panel to panel & panel through connector)	Version 2 (Jumpers are attached to power harness for power continuation from panel to panel & panel through connector)

We remanufacture three core components:

- Panel core
- Connector core
- Overhead core

Everything else is new!

The diagram below shows exactly which pieces of our products are new, and which are remanufactured parts.

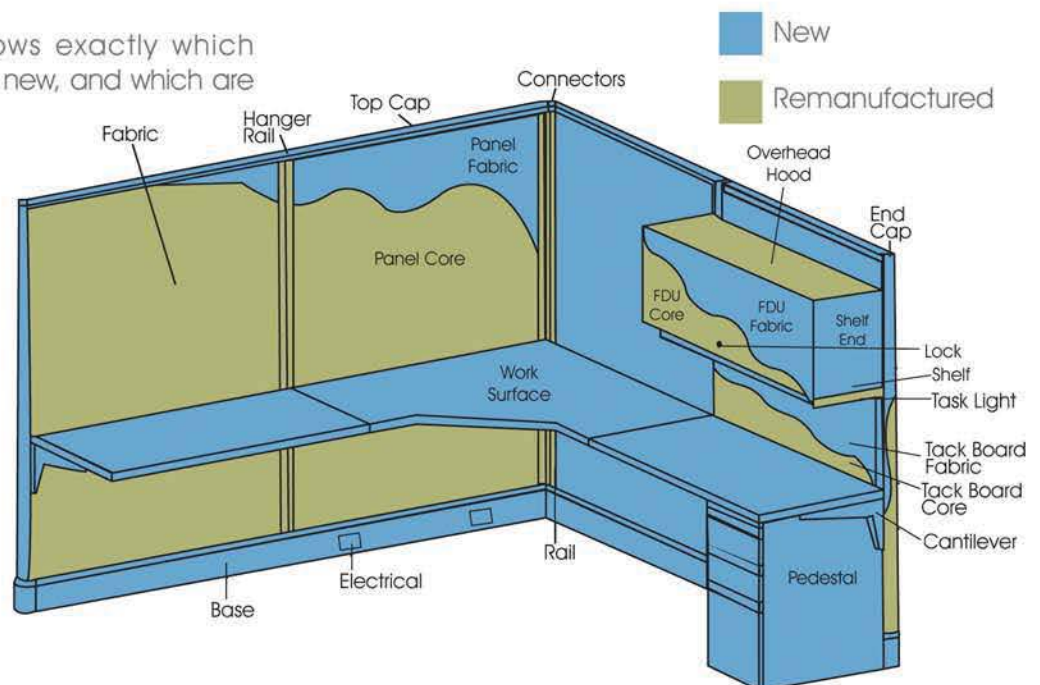

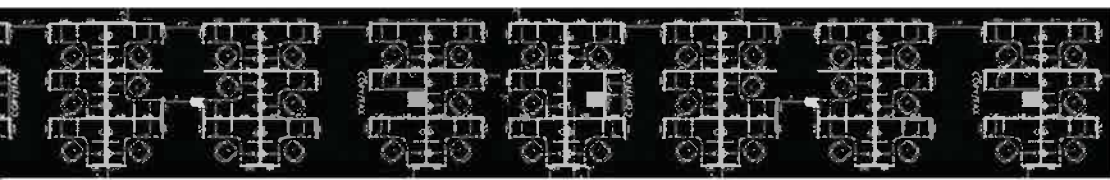

-- Sustainable Finishes

The Sustainable Series is engineered to be the best value for your money. Are you shopping for used office cubicles for the savings, but don't want to deal with the limitations? This series offers you the security you need - like a certified UL Listing and a 10-Year Warranty - along with the flexibility you desire - like color options and add-ons like glass stackers and storage accessories. Not to mention, if you ever grow your business in the future, it will be far easier to add matching components!

Open Plan Systems

Fabrics



Work Surfaces



Base



Trim



Edge



Q Eligible for Quick Ship when combined with Quick Ship options and finishes. Quick Ship orders are limited to \$150,000 list price or less for shipment in 2 weeks. Fabric is re-rolled, as shown above, except when used in combination with 85" high panels.

Colors shown are for representative purposes only. Actual swatches are available upon request. Sustainable fabrics are imported fabrics and subject to minor imperfections.

Need it Fast? Use our Lightning Program!



With these finish options, we can have your product ready to ship in as little as 1 week!

Order size and workstation components affect eligibility- ask your rep for details

Fabrics, Trim and Base

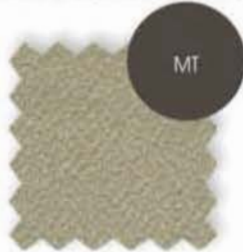

Pebble Creek
MT Trim and Base Only

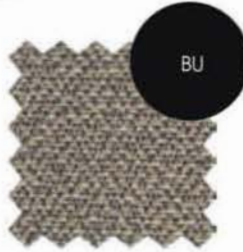

Brown's Island
BU Trim and Base Only



Colonial Downs
MT Trim and Base Only



Grey Sky
BU Trim and Base Only

Work Surface Options



Hardrock Maple
Surface and Edge



Antique White
Surface and Edge



Folkstone Grey
Surface and Edge



FINISHES
Panel Fabric: Brown's Island
Flipper Door: Painted BU
Paint/Base: BU
Work Surface/Edge: Antique White
Tackboard: Colonial Downs

#25168/2



cubicles.com

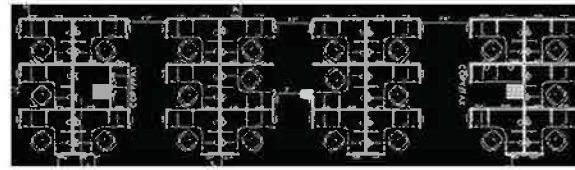

Storage & Accessories

Adding The Final Touches



Storage Options

Lateral files, pedestal files, open shelves or shelves with a locking flipper door front provide a series of versatile storage options to consider adding to your workstations. Lateral file cabinets are not only compact storage units, they can also be effectively used to divide or define your space! Lateral files range from two to five drawers and 30", 36" or 42" wide. Specify 2-drawer for in-workstation active filing demands and 3, 4, or 5 drawers for higher volumes in common areas.

Accessories

Enhance worker productivity with cubicle accessories. Specify monitor arms for improved visual multi-tasking. Select keyboard trays when user ergonomics create the demand. Use paper management trays to keep clutter in check, and LED task lights to lessen eye strain. Consider adding a work surface mounted USB charging station for the ever ubiquitous cell phones and tablets.



Tech Accessories



Paper Management



Keyboard Sets



cubicles.com



SQUARE PULL



Structural Pedestals

A lockable file that can be mounted under a work surface. 20" deep. Square pull front. Available in BU, HF, JT, LT and MT finishes.



Mobile Pedestals

Locking mountable storage that is easily accessible yet fits under a work surface. 20" deep. Square pull front. Available in BU, HF, JT, LT and MT finishes.



2-Drawer Lateral

A lockable file with counterweight that can be used freestanding or mounted under a work surface. Accommodates legal or letter size hanging files. 30" wide. Square pull front. Available in BU, HF, JT, LT and MT finishes.

FULL PULL



Structural Pedestals

A lockable file that can be mounted under a work surface. 21" or 23" deep. Full pull front. Available in BU, HF, MT, and WF finishes.



Mobile Pedestals

Locking mountable storage that is easily accessible yet fits under a work surface. 20" deep. Full pull front. Available in BU, HF, MT, and WF finishes.



2-Drawer Lateral

A lockable file with counterweight that can be used freestanding or mounted under a work surface. Accommodates legal or letter size hanging files. 30" wide. Full pull front. Available in BU, HF, MT, and WF finishes.



Hanging Pedestal

Lockable storage mounted under a work surface. A convenient solution for hanging files and documents. 20" deep. Full pull front. Available in BU, HF, MT, and WF finishes.



Budget Pedestal

Lockable storage for the budget-minded. Nylon roller suspension for easy access yet fits under the work surface. 21" deep. Full pull front. Available in BU, HF, MT, and WF finishes.



Tower

Lockable storage. 24" wide by 24" deep by 63" high. Full pull front. Available in BU, HF, MT, and WF finishes.



Seat Cushion for Pedestals

Seat cushion pedestals that can be upholstered with any fabric. Ideal for collaborative meetings.



cubicles.com



Coat Hook
List Price \$30



Marker Board
List Price \$235-459



Pencil Drawer
List Price \$89



Universal Coat Hook
List Price \$30



Binder Holder
List Price \$55



Diagonal Paper Tray
List Price \$92



Tool Rail Bar
List Price \$235-459



Vertical Paper Tray
List Price \$55



cubicles.com

**Note : List prices are not your discounted price!
Please inquire for Pricing!**

888-442-8242



AKA/REFURB SET



AKAREFURB	Lowest priced set available.	\$295
------------------	-------------------------------------	--------------

Set Includes:

SKU	Description	List
(Arm) AKAUSED#	17" track; swiveling, knobless +/- movement	\$199
(Tray) WKTRAYBUDGET	23" wide tray; vinyl-coated MDF material	\$99

VALUE SET



AKAVALUE	Our most popular set.	\$395
-----------------	------------------------------	--------------

Set Includes:

SKU	Description	List
(Arm) WKARMEZS	21" track; 360° swivel; knobless +/- 15° tilt; 5.25" spring-assisted height adjustment	\$269
(Tray) WKTRAYVALUE	20" wide tray; vinyl-coated MDF material; leatherette-covered wrist rest; mouse tray with swivel function (can be used left or right handed)	\$169

VALUE SET EXTENDED



AKAVALUEEXT	Extended version of the Value Set.	\$425
--------------------	---	--------------

Set Includes:

SKU	Description	List
(Arm) WKARMEZX	23" track; 360° swivel; knobless +/- 15° tilt; 7.25" spring-assisted height adjustment	\$279
(Tray) WKTRAYVALUE	20" wide tray; vinyl-coated MDF material; leatherette-covered wrist rest; mouse tray with swivel function (can be used left or right handed)	\$169

BETTER SET



AKANEW	Sold as set only. Extra wide tray slides and comfortably fits keyboard and mouse.	\$449
---------------	--	--------------

Part	Description
Arm	21" track; swivel; one-finger control with +/- motion; manual adjustment tilt with lock
Tray	27" wide tray; vinyl-coated MDF material; fabric-covered wrist rest

BEST SET



AKAMINICOBRA SLIMFORM	Named our Best Set for a reason.	\$725
------------------------------	---	--------------

Set Includes:

SKU	Description	List
(Arm) WKARMMINICOBRA	21" track; 360° swivel; soft touch wheel with +10°/-20° tilt; 8" height adjustment	\$450
(Tray) WKTRAY19	20" wide tray; graphite gray MDF material; foam wrist rest; mouse tray with gel mouse pad and face (can be used left or right handed)	\$299

BEST SET EXTENDED



AKACOBRA SLIMFORM	Extended version of our Best Set.	\$725
--------------------------	--	--------------

Set Includes:

SKU	Description	List
(Arm) WKARMCOBRA	23" track; 360° swivel; soft touch wheel with +10°/-20° tilt; 12.5" height adjustment	\$450
(Tray) WKTRAY19	20" wide tray; graphite gray MDF material; foam wrist rest; mouse tray with gel mouse pad and face (can be used left or right handed)	\$299



cubicles.com

**Note : List prices are not your discounted price!
Please inquire for Pricing!**

888-442-8242



MP3 Player & Data/ Power Units



SKU	Description	List
FLIPODOCK	Grommet Mount 1 Pod Port-FCDock-Inc.-Power Cable/USB	\$295
FLPDMFM	Recessed Power Port- FC620- 2 REC, 1RJ11, 1RJ45, 2 USB	\$295

Note:
FLIPODOCK is a MP3 player dock that allows access to your MP3 player or phone throughout the day. FLPDMFM is a data/power unit. Both are UL approved and can be surface mounted.

Adjustable Monitor Arms



*Clamp Mount Shown

SKU	Description	List
WKTREX	Flat Screen Monitor Support Arm, Clamp Mount	\$725
WKTREX2	Flat Screen Dual Monitor Support Arm, Clamp Mount	\$1155
WKGRTREX	Flat Screen Monitor Support Arm, Grommet Mount	\$725
WKGRTREX2	Flat Screen Dual Monitor Support Arm, Grommet Mount	\$1155

Support Arm



SKU	Description	List
WKTREX3	Flat Screen Notebook Support Arm w/Tablet Holder	\$695

Note:
Mounting Hardware not Included

Easy Cinch Computer Case Holder



SKU	Description	List
WKEZCINCH	Strap Supported CPU under Desktop	\$309

Metal CPU Holder



SKU	Description	List
WKEZCINCH. METAL	Metal Supported CPU under Desktop	\$359



cubicles.com

**Note : List prices are not your discounted price!
Please inquire for Pricing!**

888-442-8242



VALUE SERIES



\$189

5688



\$139

4032



\$159

4019



\$229

4008



\$95

3159 (sold in sets of 4)



\$105

3119 (sold in sets of 4)

ELEVATION SERIES



\$239

B1FS/B1



\$399

B3



\$299

B4



\$299

B6



\$239

B8



\$215

C8



cubicles.com

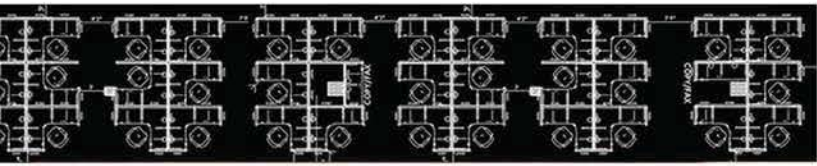

Design Capabilities

Office space planning is a vital component in achieving an optimal office space plan. To achieve your desired goals, working with someone who is knowledgeable in both the art and science of **Computer Aided Design (CAD)** can be an invaluable asset and one of your most effective office space planning tools.

An Office Space Planner will be able to assist you in developing a successful office space plan that will take all the necessary factors into account, including minimum fire safety and/or ADA requirements, open plan vs. high privacy environments, electrical & data cabling arrangements, noise/acoustics, departmentalized workflow, and more.

At the core of Cubicles.com is a team of experts in the field of office space planning and office interior design. Give us your office space dimensions and we will return a plan that meets your needs, fits your budget and exceeds your expectations.

If you want the office space design experts at cubicles.com to hit the ground running for your project, just [send us the rough stuff](#) and we'll turn it around in no time flat!

2D

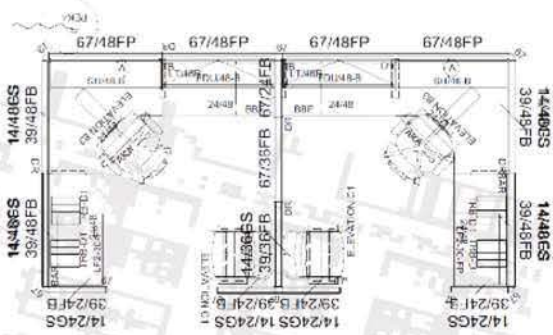

3D

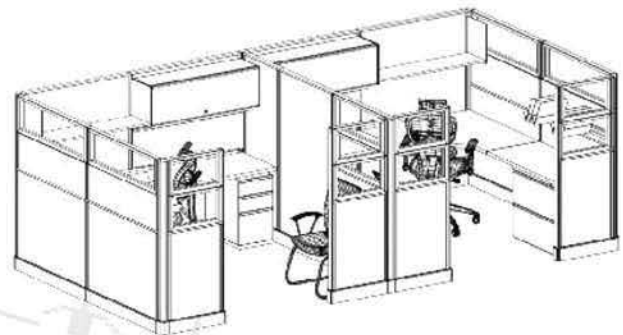

3D Visual Impressions Professional Renderings





Cubicles.com - The Open Plan Advantage

With more than 80 years of combined cumulative experience in the office furniture industry Cubicles.com and Open Plan Systems are experts in planning, designing, specifying the office and manufacturing workstations.

Quality

Our workstations are "A" Grade quality. Quality achieved by relentlessly pursuing the highest standards in the manufacturing process, and by utilizing proven techniques and technologies that ensure quality products and unparalleled service and savings.

Value Pricing

OPS remanufactures the old or fabricates the completely brand new. When the bottom line demands, we can blend the two into sustainable cost effective office environments. This is achieved without sacrificing quality or limiting aesthetic possibilities.

We do this at a significant cost savings that is often 20-40% below the cost of larger manufacturers and their comparable systems! If you're not convinced, put us through the paces and allow us to prove the value our furniture can bring to your project.

UL-Approved

We take an active interest in the safety of your workplace. Every fabric we use is Class A fire rated. Every electrical component in both new and remanufactured products are (UL) approved by Underwriters Laboratories Inc.

Many insurance policies have clauses limiting the insurance company's liability in the case of a claim due to the failure of a non-UL-listed device. Protect your investments by making sure the product you buy is UL, BIFMA, and NEC-approved.

Warranty

All new and remanufactured system products are covered by a 10-year warranty.

Green Initiative

More than a Green Initiative, sustainability is a core business strategy and responsibility. With our driven eco-friendly efforts, OPS takes a Kaizen approach to environmental innovations, leadership efforts and quality performance. OPS is very proud of being a U.S. Green Building Council member and recycles the following:

- Paint
- Fabric Waste
- Wood Waste
- Steel
- Cardboard
- Aluminum
- Plastic Wrap
- Light Bulbs
- Pallets
- Aerosol Cans
- Office Waste

Each Year, We Recycle:

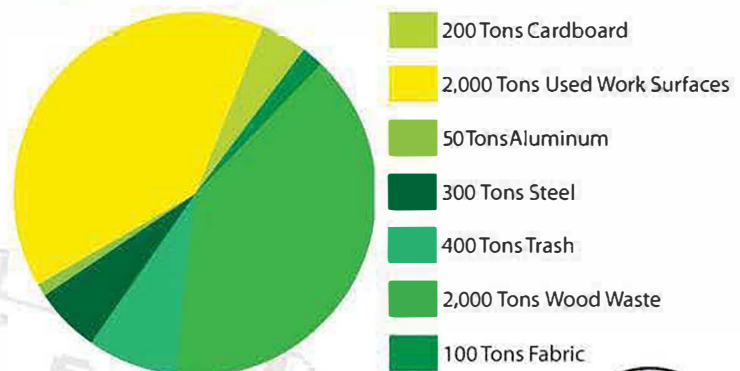

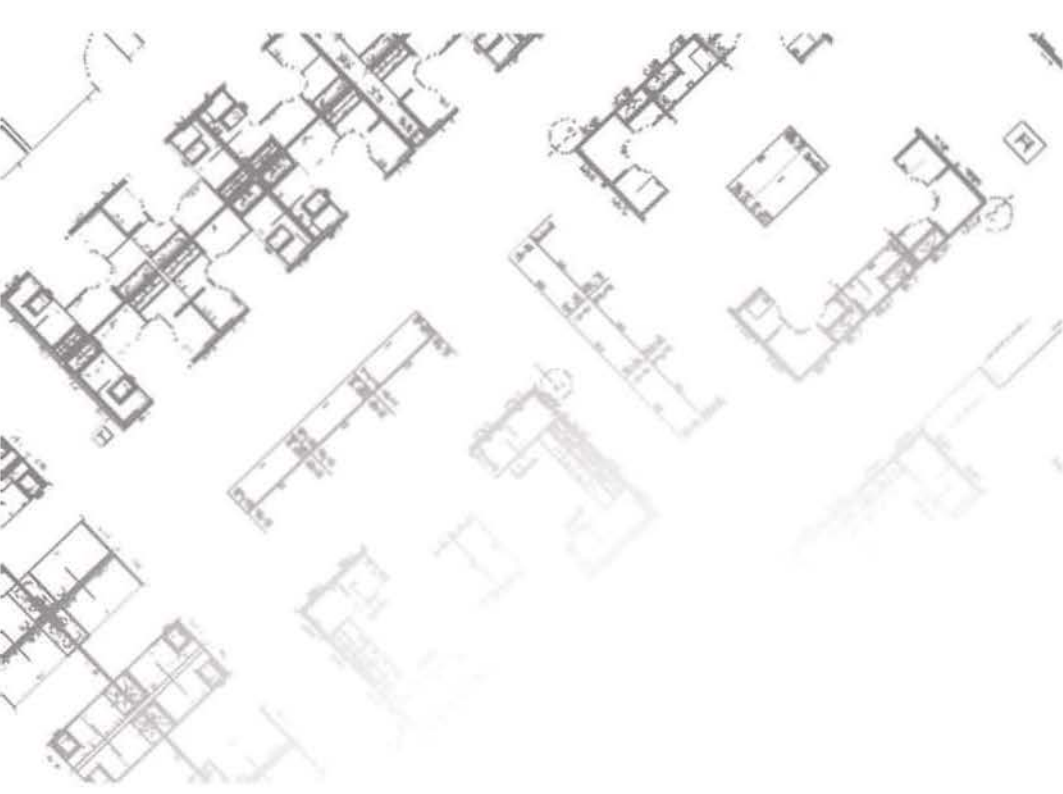

Thin, Open Minds.
Miller AO2 Style

Product

What are you waiting for?
Call us Today!

 **888-442-8242**



cubicles.com

