

# OVERALL 2D LAYOUT

## SCOPE

**D2 MODULAR WALL OFFICE SYSTEM | POWERED | THIN BASE | GRADE 2 FINISHES**

### AREA A

- [1] 10' X 11'-6" X 85" / 107"H ACOUSTIC POWERED MODULAR WALL OFFICES W/ HINGED DOOR
- [1] 10'-6" X 11'-6" X 85" / 107"H ACOUSTIC POWERED MODULAR WALL OFFICES W/ HINGED DOOR
- [2] 6'X8' U-SHAPED DESKS W/
  - [1] BOX-BOX-FILE & [1] FILE-FILE PEDESTAL /EA
  - [1] 24"W & [1] 42"W OVERHEAD STORAGE /EA
  - [1] 30"W OPEN SHELF /EA
  - [1] 14"H FROSTED MODESTY PANEL /EA
- [1] 6'X7'-6" L-SHAPED POWERED DESK W/
  - [1] BOX-BOX-FILE PEDESTAL
  - [1] 14"H FROSTED MODESTY PANEL

### AREA B

- [2] 10'-6" X 11'-9" X 107"H POWERED ACOUSTIC MODULAR WALL OFFICES W/ HINGED DOOR
- [2] 6'X8' U-SHAPED DESKS W/
  - [1] BOX-BOX-FILE & [1] FILE-FILE PEDESTAL /EA
  - [1] 24"W & [1] 42"W OVERHEAD STORAGE /EA
  - [1] 30"W OPEN SHELF /EA
  - [1] 14"H FROSTED MODESTY PANEL /EA

### EQUIPMENT STATION

- [1] 2' X 4' X 39"H NON-POWERED STATION

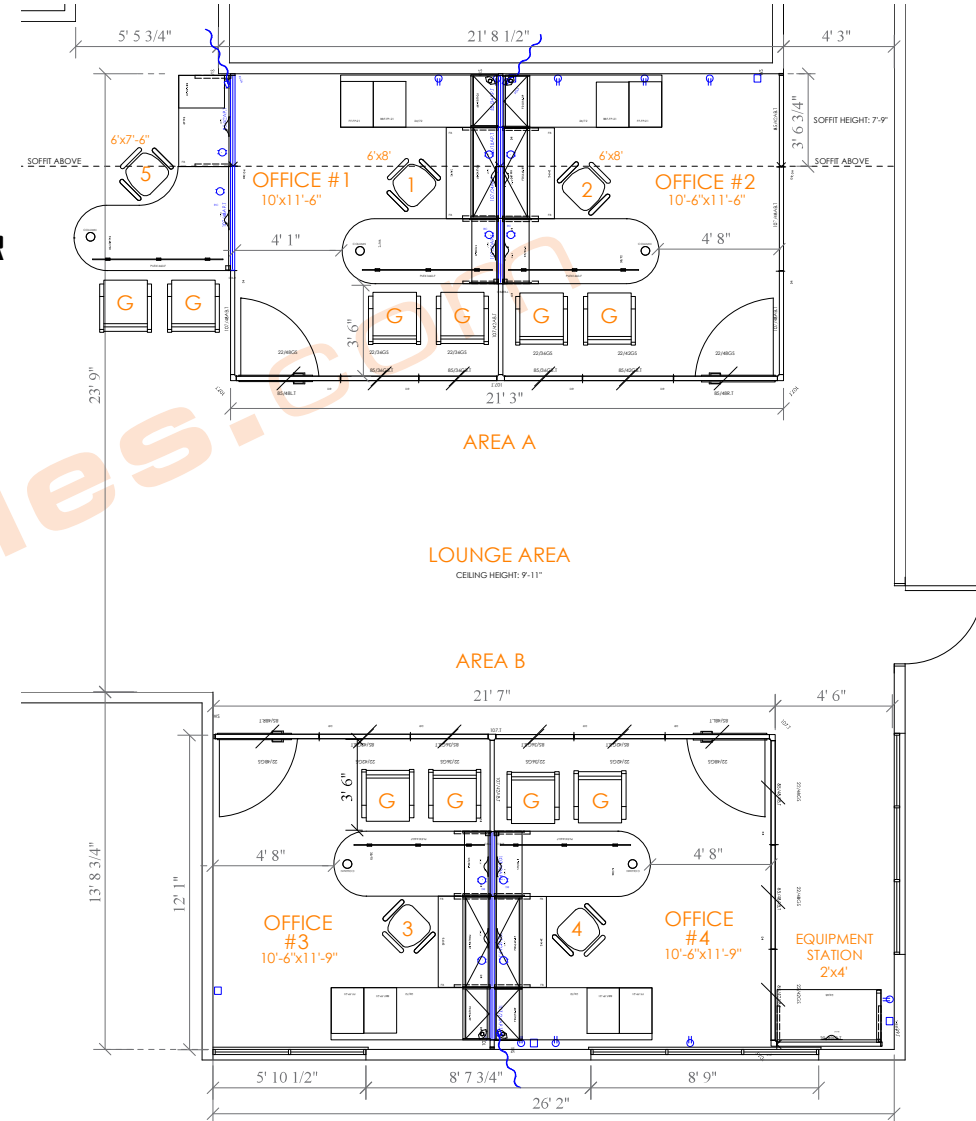

**IMPORTANT NOTE: 4" GAP BETWEEN WORKSURFACE AND BACK WALL IN OFFICES #3 & #4**

- NEW FURNITURE
- POWERED ELEMENTS
- NOTES

\*\* SEATING NOT INCLUDED - AVAILABLE UPON REQUEST